

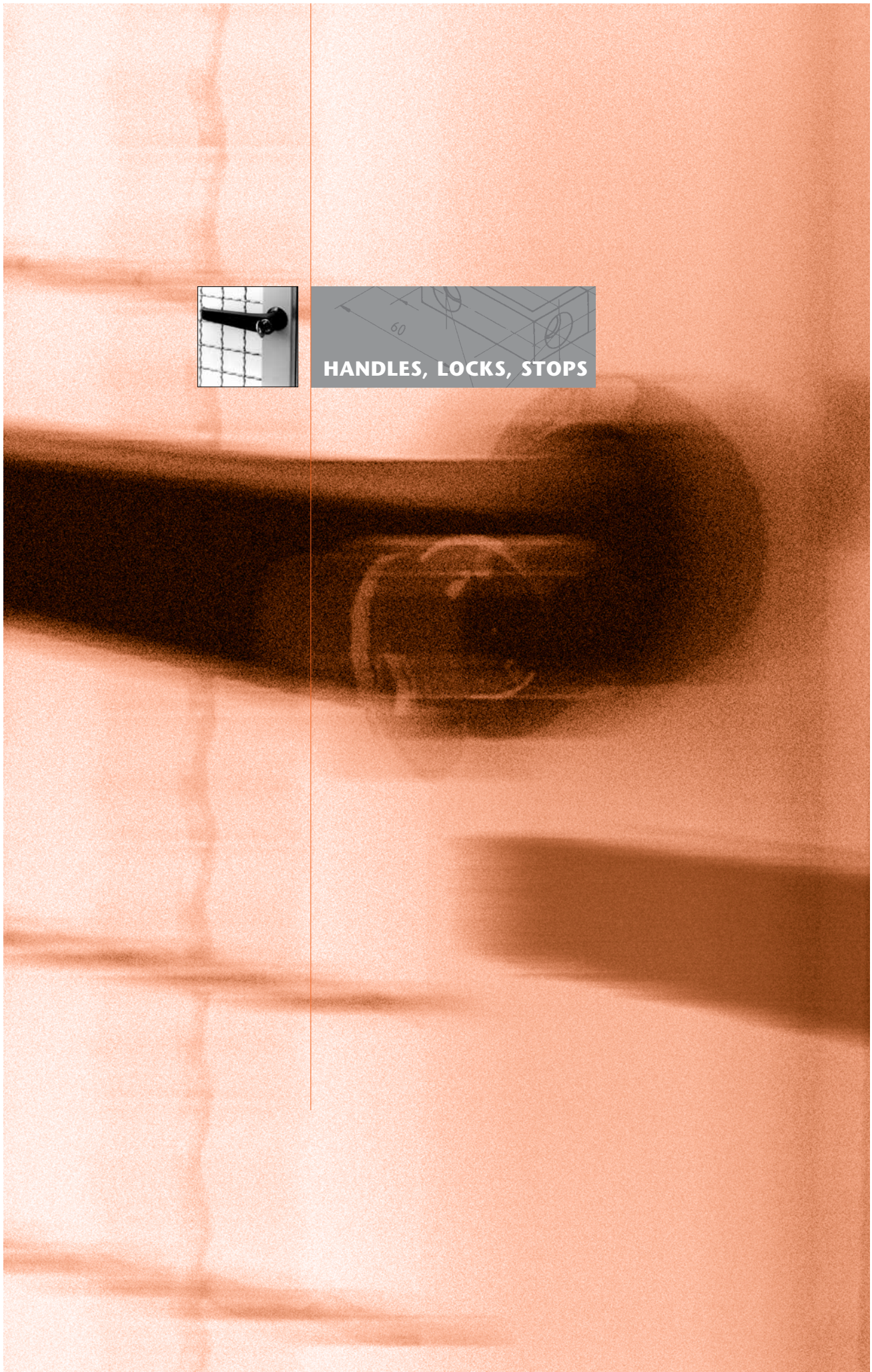

HANDLES, LOCKS, STOPS



HANDLE AL

Part. N° 21.1138/0

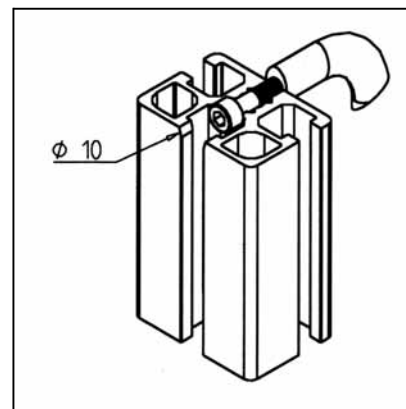
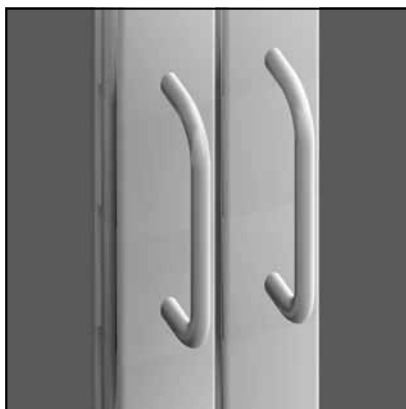
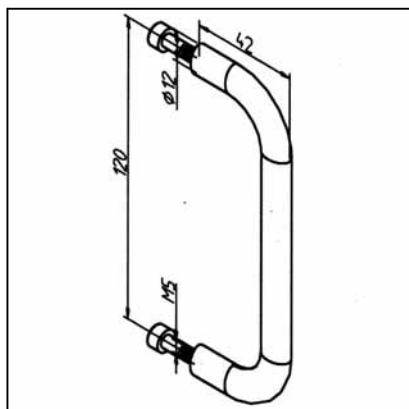

TECHN. DATA / ITEMS SUPPLIED

- Aluminium, natural anodized
- Fixing kit
- Weight 0,050 kg

APPLICATIONS

- Show cases
- Cabinets
- Light doors

ASSEMBLY

- Use fixing kit from supply schedule
- With step drilling $\varnothing 10 \text{ mm} \times 5,5 \text{ mm}$ respectively through hole $\varnothing 5,5$

HANDLE AL ANGLED

Part. N° 21.1348/0

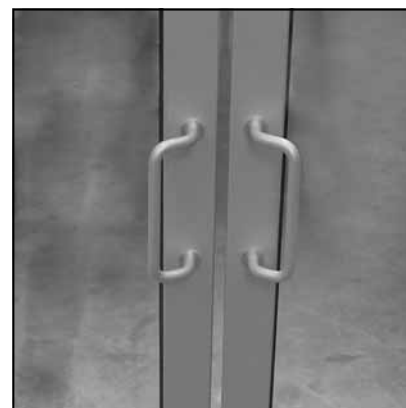
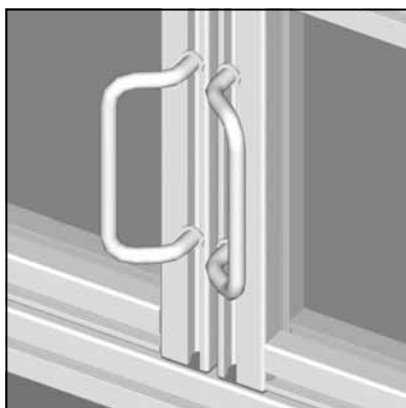
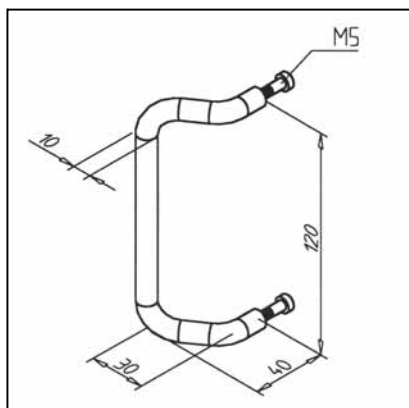

TECH. DATA / ITEMS SUPPLIED

- Aluminium natural, anodized
- Fixing kit
- Weight 0,050 kg

APPLICATIONS

- Show cases
- Cabinets
- Light doors

ASSEMBLY

- Use fixing kit from supply schedule
- 2 step drills $\varnothing 10 \text{ mm} \times 5,5 \text{ mm}$ or through-bores $\varnothing 5,5 \text{ mm}$ in 120 mm distance

PROFILE HANDLE

Part. N° 21.1051/0

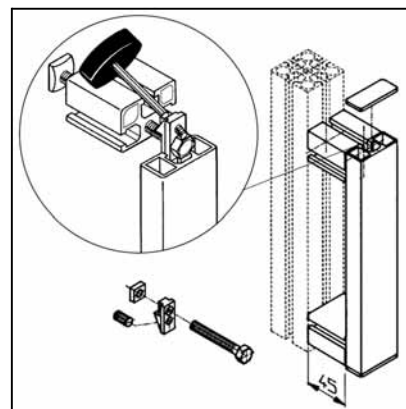
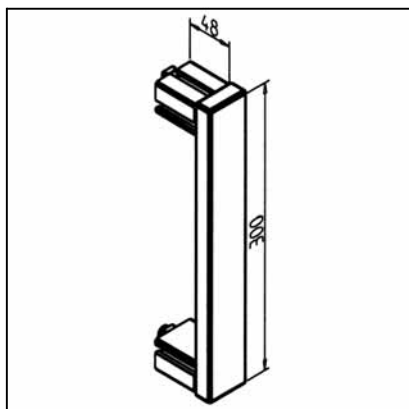

TECHN. DATA / ITEMS SUPPLIED

- Assembly kit made from MiniTec aluminium profiles
- Fixing kit
- Weight 0,480 kg
- Length 300 mm
- Other lengths on request

APPLICATIONS

- Handle for very large doors, lids, trolleys, removable panel elements

ASSEMBLY

- Put the screw with fastener through the bore of the distance piece
- Tighten power-lock fastener
- Clip on end caps

CLOSED PROTECTIVE HANDLE

Part. N° 21.1048/0

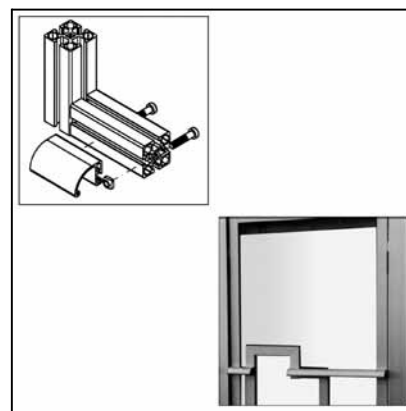
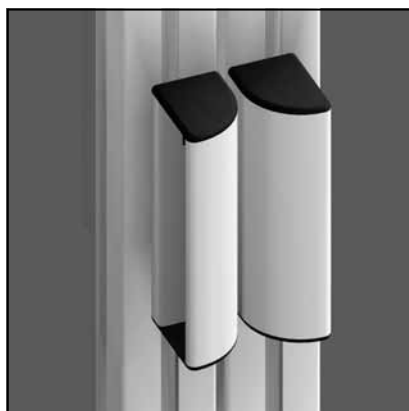
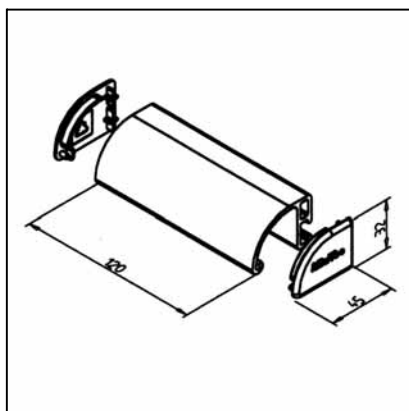

TECHN. DATA / ITEMS SUPPLIED

- Aluminium anodized
- End caps
- Without fixing kit
- Weight 0,113 kg
- Length 120 mm
- Other lengths on request

APPLICATIONS

- For doors
- Lids
- Guards
- Furniture

ASSEMBLY

- On profile groove with 2 cap screws M6 x 20 and square nut M6
- Directly on panel element with cap screw M6, length according to material thickness
- Assembly can also be carried out from the rear side; for this purpose insert square nut M6

HANDLE 90

Part. N° 21.1099/1

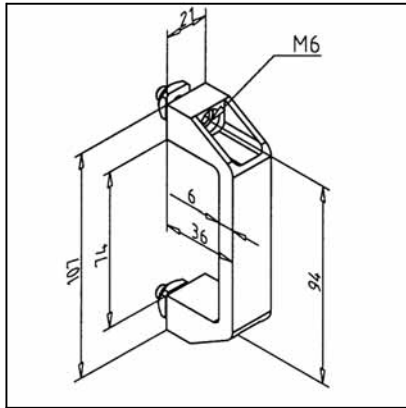

TECHN. DATA / ITEMS SUPPLIED

- PA 6.6, grey
- On request also deliverable in black
Part N° 21.1099/0
- Fixing kit
- Weight 0,025 kg

APPLICATIONS

- For doors
- Lids
- Guards

ASSEMBLY

- Use fixing kit from supply schedule
- Directly on panel element with cap screw M6, length according to material thickness
- Assembly can also be carried out from the rear side

HANDLE 120

Part. N° 21.1092/1

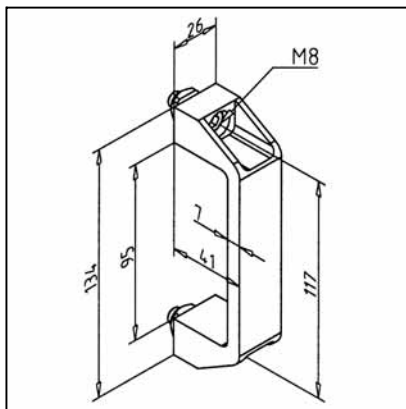

TECHN. DATA / ITEMS SUPPLIED

- PA 6.6, grey
- On request also deliverable in black
Part N° 21.1092/0
- Fixing kit
- Weight 0,074 kg

APPLICATIONS

- For doors
- Lids
- Guards

ASSEMBLY

- Use fixing kit from supply schedule
- Directly on panel element with cap screw M8, length according to material thickness
- Assembly can also be carried out from the rear side

HANDLE 180

Part. N° 21.1094/1

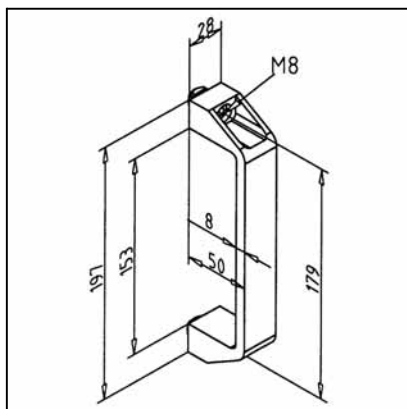

TECHN. DATA / ITEMS SUPPLIED

- PA 6.6, grey
- On request also deliverable in black
Part N° 21.1094/0
- Fixing kit
- Weight 0,099 kg

APPLICATIONS

- For doors
- Lids
- Guards

ASSEMBLY

- Use fixing kit from supply schedule
- Directly on panel element with cap screw M8, length according to material thickness
- Assembly can also be carried out from the rear side

DOOR LOCK

Part. N° 21.1750/5

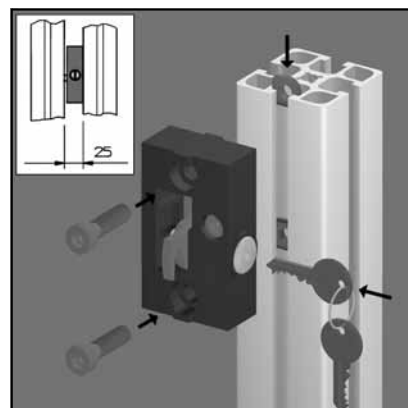
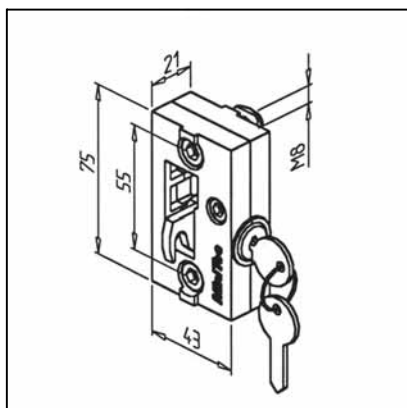

TECHN. DATA / ITEMS SUPPLIED

- PA 6.6, grey
- On request also deliverable in black
Part N° 21.1750/0
- Cylinder lock with 2 keys
- Lock, steel, zinc-plated
- Fixing kit
- Weight 0,195 kg

APPLICATIONS

- For doors
- Lids
- Guards

ASSEMBLY

- Use fixing kit from supply schedule
- Door lock meshes into groove of opposite profile
- Suitable for left and right hand mounting
- Suitably with lock 8 **Part N° 21.1715/0**

CATCH 8

Part. N° 21.1715/0

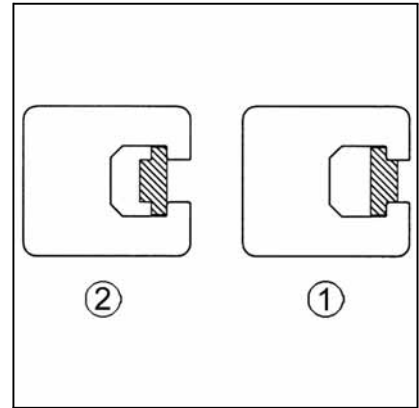
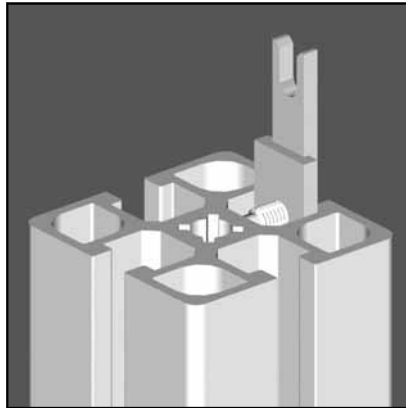
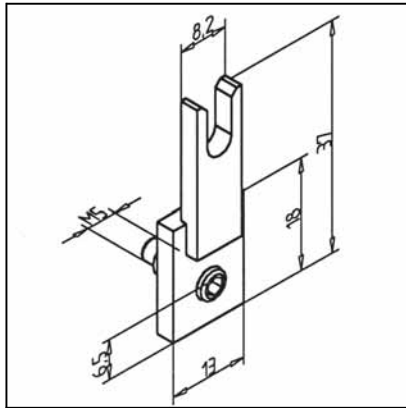

TECHN. DATA / ITEMS SUPPLIED

- Aluminium natural, anodized
- With set-screw
- Weight 0,015 kg

APPLICATIONS

- Locking of sliding doors, swing doors with door lock

ASSEMBLY

- Slip the catch into profile groove
- 1) Catch open: for swing doors
- 2) Catch closed (as shown in the picture): for sliding doors
- Fix in desired position with set-screw

CYLINDER LOCK

Part. N° 21.1752/0

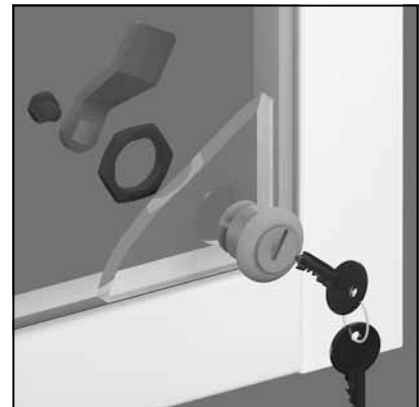
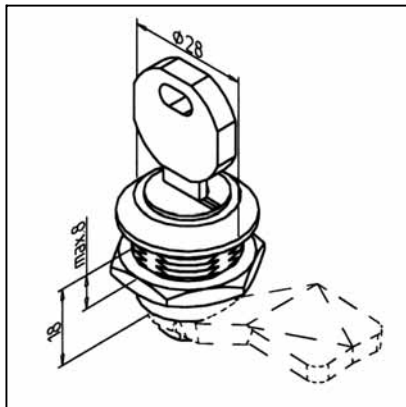

TECHN. DATA / ITEMS SUPPLIED

- Brass, chrome plated
- Without lock
- 2 keys
- Weight 0,100 kg

APPLICATIONS

- Light doors from panel elements up to 8 mm thickness

ASSEMBLY

- Bore Ø 22 mm in panel element
- Position: 22 mm from edge in both directions
- Selection of locks see page 124

BOLT LOCK 32 FOR FOUR-FACED KEY

Part. N° 21.1087/6

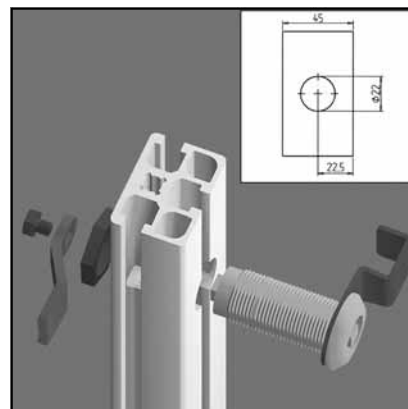
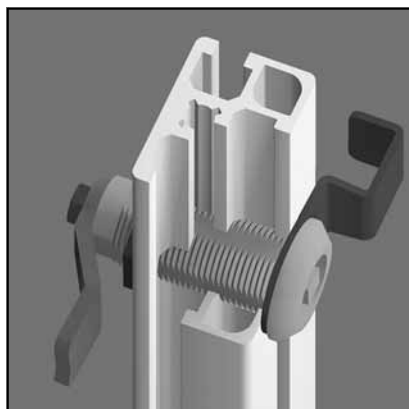
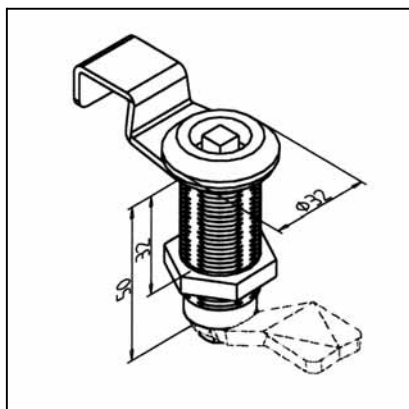

TECHN. DATA / ITEMS SUPPLIED

- Housing GD Zn, black
- With four-faced key
- Opener, black
- Fixing nut, steel, zinc-plated
- Without lock
- Weight 0,179 kg

APPLICATIONS

- For profiles 32
- Locking of doors and lids in guard units

ASSEMBLY

- Bore Ø 22 mm in the middle of the profile
- Tighten bolt lock from the rear with fixing nut
- Selection of locks see page 124

BOLT LOCK 32 SOCKET HEX HEAD WRENCH 10 A/F

Part. N° 21.1087/8

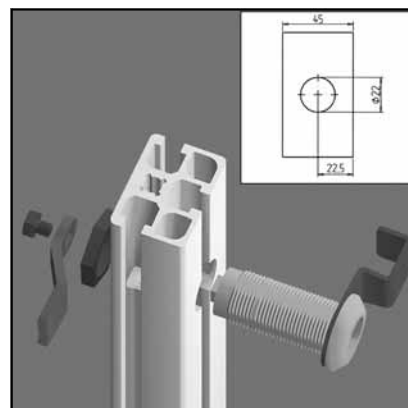
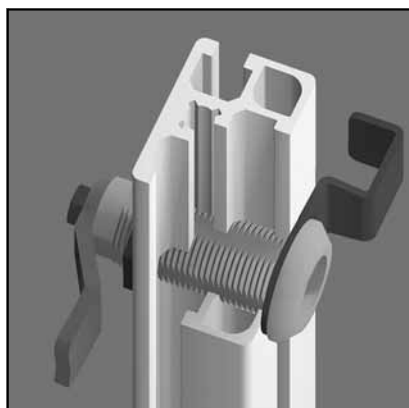
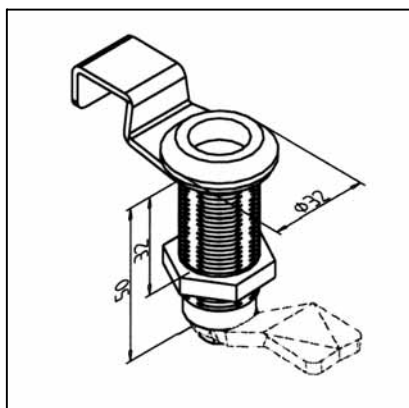

TECHN. DATA / ITEMS SUPPLIED

- Housing GD Zn, black
- For socket hex head wrench 10 A/F
- Opener, black
- Fixing nut, steel, zinc-plated
- Without lock
- Weight 0,102 kg

APPLICATIONS

- For profiles 32
- Locking of doors and lids in guard units

ASSEMBLY

- Bore Ø 22 mm in the middle of the profile
- Tighten bolt lock from the rear with fixing nut
- Selection of locks see page 124

BOLT LOCK 45 FOR-FACED KEY

Part. N° 21.1087/7

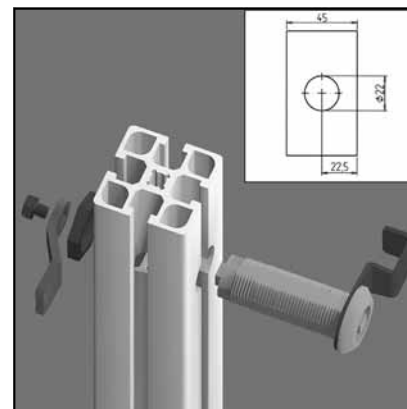
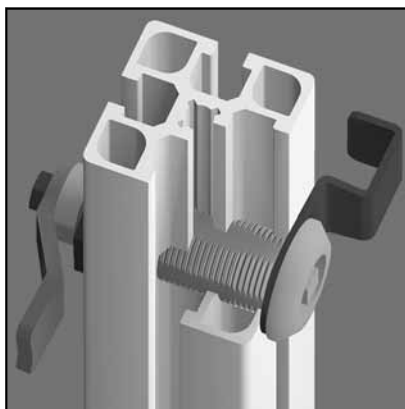
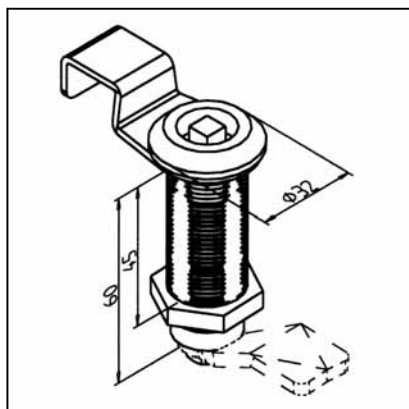

TECHN. DATA / ITEMS SUPPLIED

- Housing GD Zn, black
- With four-faced key
- Opener, black
- Fixing nut, steel, zinc-plated
- Without lock
- Weight 0,197 kg

APPLICATIONS

- For profiles 45
- Locking of doors and lids in guard units

ASSEMBLY

- Bore Ø 22 mm in the middle of the profile
- Tighten bolt lock from the rear with fixing nut
- Selection of locks see page 124

BOLT LOCK 45 HEX HEAD WRENCH 10 A/F

Part. N° 21.1087/9

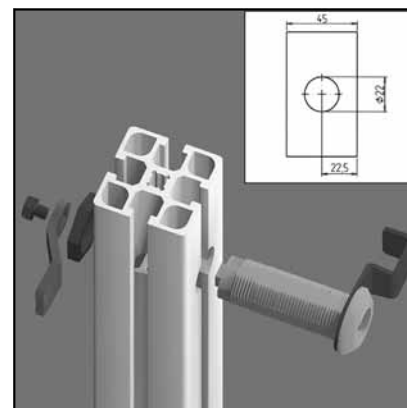
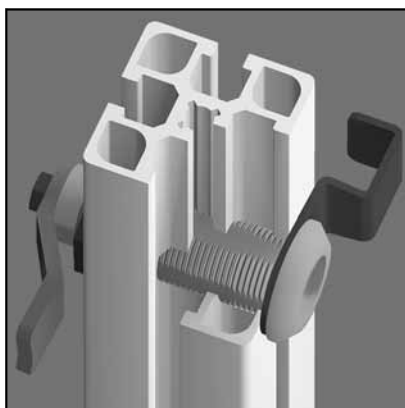
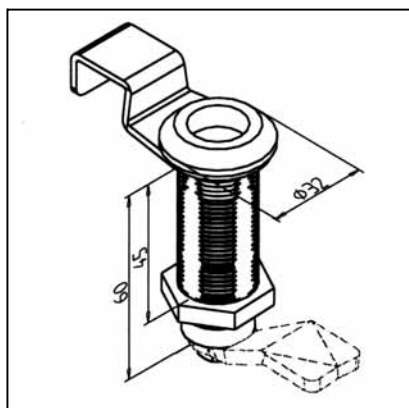

TECHN. DATA / ITEMS SUPPLIED

- Housing GD Zn, black
- For socket hex head wrench 10 A/F
- Opener, black
- Fixing nut, steel, zinc-plated
- Without lock
- Weight 0,111 kg

APPLICATIONS

- For profiles 45
- Locking of doors and lids in guard units

ASSEMBLY

- Bore Ø 22 mm in the middle of the profile
- Tighten bolt lock from the rear with fixing nut
- Selection of locks see page 124

HANDLE 32 WITHOUT PROFILE CYLINDER LOCK

Part. N° 21.1087/4

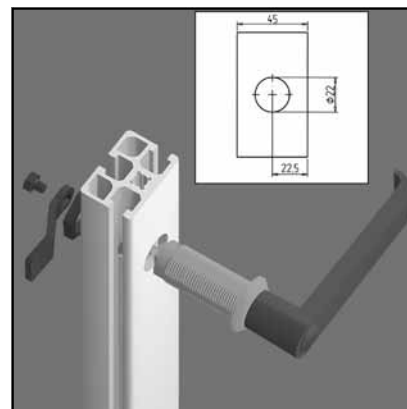
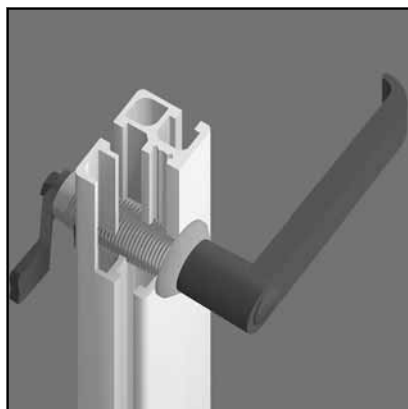
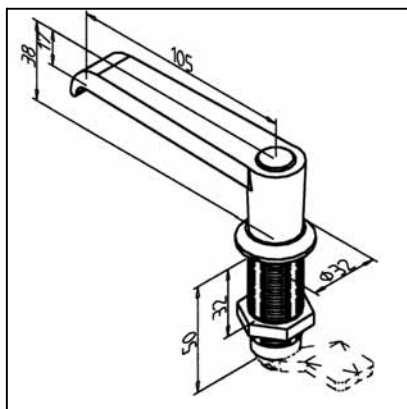

TECHN. DATA / ITEMS SUPPLIED

- Housing PA/GD Zn, grey
- On request also deliverable in black
Part N° 21.1087/2
- Fixing nut, steel, zinc-plated
- Without lock
- Weight 0,172 kg

APPLICATIONS

- For profiles 32
- Locking of doors and lids in guard units

ASSEMBLY

- Bore Ø 22 mm in the middle of the profile
- Tighten bolt lock from the rear with fixing nut
- Selection of locks see page 124

HANDLE 32 WITH PROFILE CYLINDER LOCK

Part. N° 21.1091/4

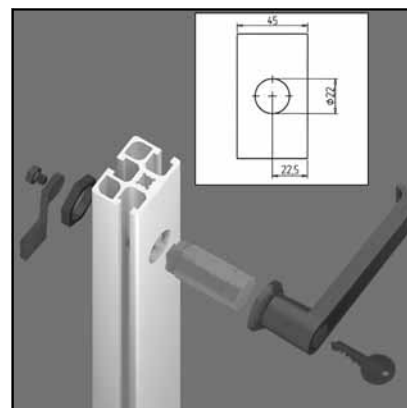
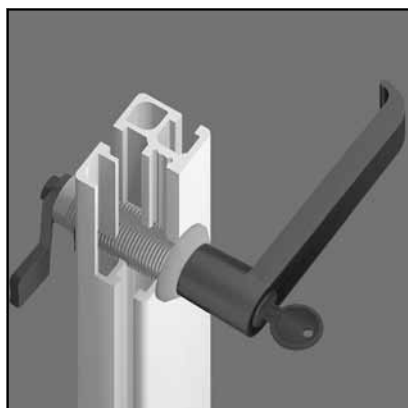
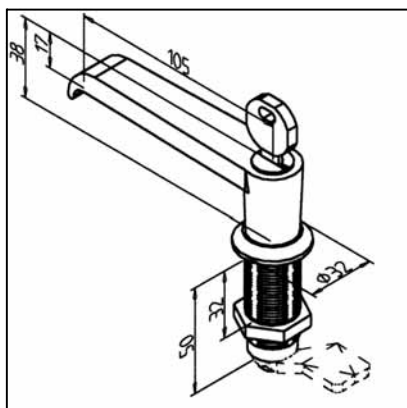

TECHN. DATA / ITEMS SUPPLIED

- Housing PA/GD Zn, grey
- On request also deliverable in black
Part N° 21.1091/2
- Fixing nut, steel, zinc-plated
- Without lock
- Weight 0,211 kg

APPLICATIONS

- For profiles 32
- Locking of doors and lids in guard units

ASSEMBLY

- Bore Ø 22 mm in the middle of the profile
- Tighten handle lock from the rear with fixing nut
- Selection of locks see page 124

HANDLE 45 WITHOUT PROFILE CYLINDER LOCK

Part. N° 21.1087/3

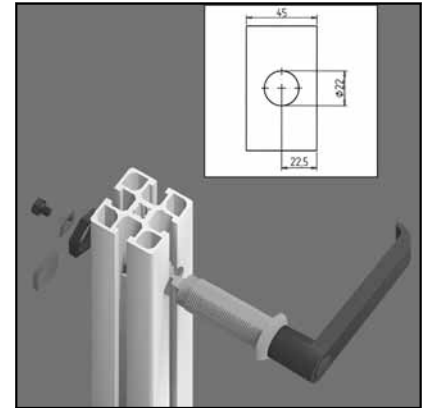
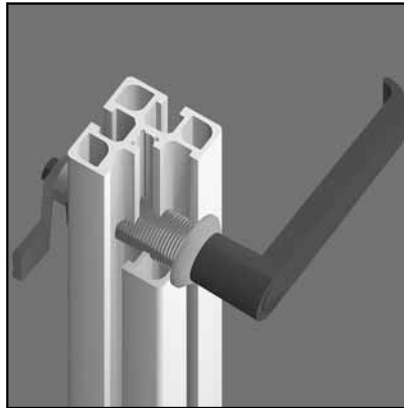
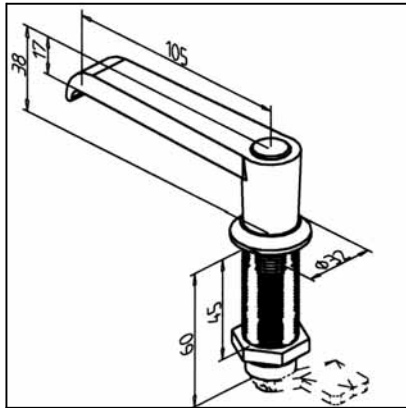

TECHN. DATA / ITEMS SUPPLIED

- Housing PA/GD Zn, grey
- On request also deliverable in black
Part N° 21.1087/1
- Fixing nut, steel, zinc-plated
- Without lock
- Weight 0,195 kg

APPLICATIONS

- For profiles 45
- Locking of doors and lids in guard units

ASSEMBLY

- Bore Ø 22 mm in the middle of the profile
- Tighten handle lock from the rear with fixing nut
- Selection of locks see page 124

HANDLE 45 WITH PROFILE CYLINDER LOCK

Part. N° 21.1091/3

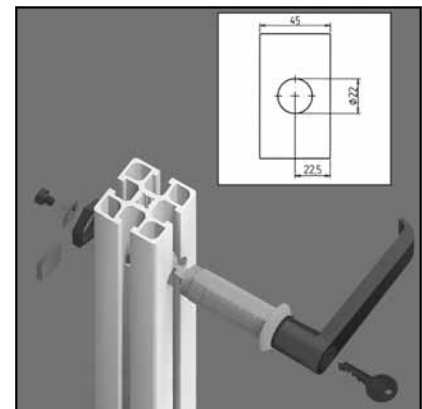
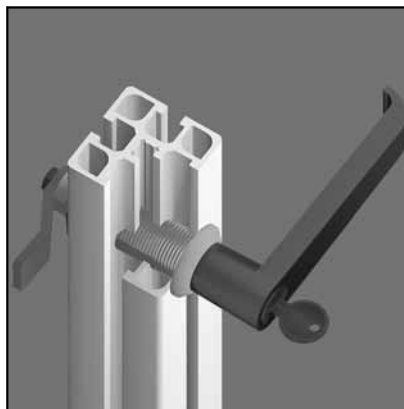
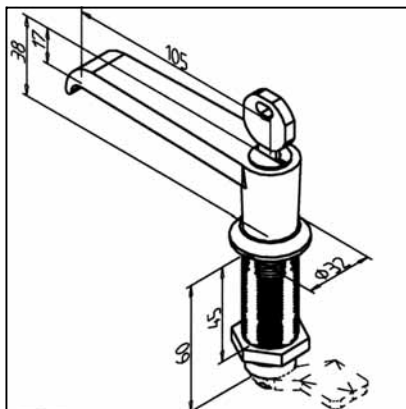

TECHN. DATA / ITEMS SUPPLIED

- Housing PA/GD Zn, grey
- On request also deliverable in black
Part N° 21.1091/1
- Fixing nut, steel, zinc-plated
- Without lock
- Weight 0,230 kg

APPLICATIONS

- For profiles 45
- Locking of doors and lids in guard units

ASSEMBLY

- Bore Ø 22 mm in the middle of the profile
- Tighten handle lock from the rear with fixing nut
- Selection of locks see page 124

T-HANDLE 19

Part. N° 21.1015/2

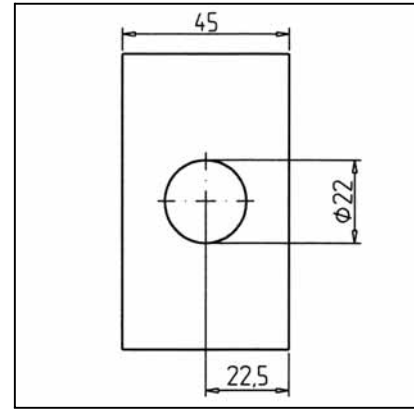
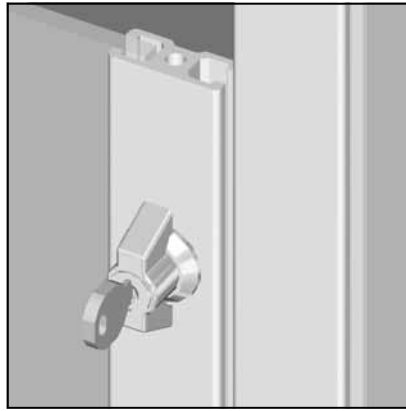
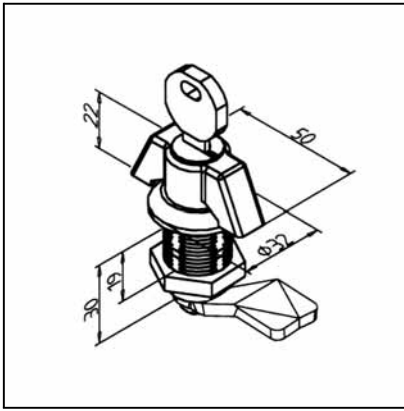

TECHN. DATA / ITEMS SUPPLIED

- GD Zn, chrome plated
- With profile cylinder lock
- Fixing nut, steel, zinc-plated
- Without lock
- Weight 0,168 kg

APPLICATIONS

- For profiles 19
- Locking of doors and lids in guard units

ASSEMBLY

- Bore Ø 22 mm in the middle of the profile
- Tighten T-handle lock from the rear with fixing nut
- Selection of locks see page 124

T-HANDLE 32

Part. N° 21.1015/0

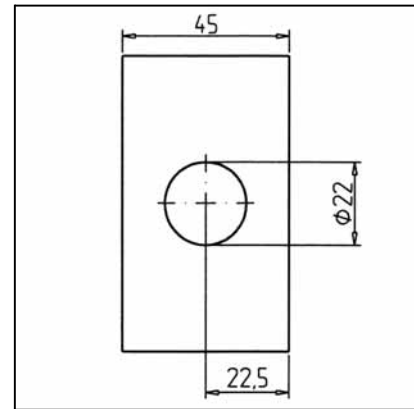
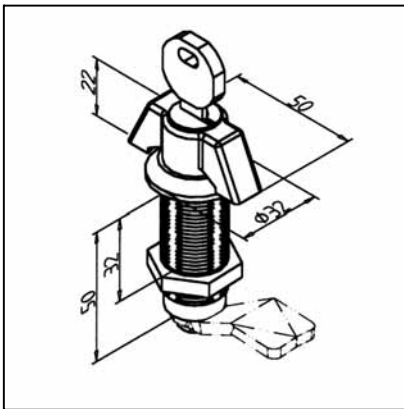

TECHN. DATA / ITEMS SUPPLIED

- GD Zn, chrome plated
- With profile cylinder lock
- Fixing nut, steel, zinc-plated
- Without lock
- Weight 0,188 kg

APPLICATIONS

- For profiles 32
- Locking of doors and lids in guard units

ASSEMBLY

- Bore Ø 22 mm in the middle of the profile
- Tighten T-handle lock from the rear with fixing nut
- Selection of locks see page 124

T-HANDLE 45

Part. N° 21.1015/1

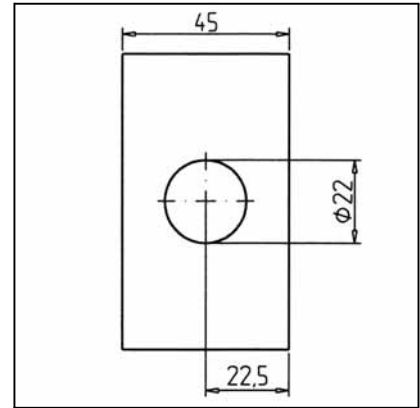
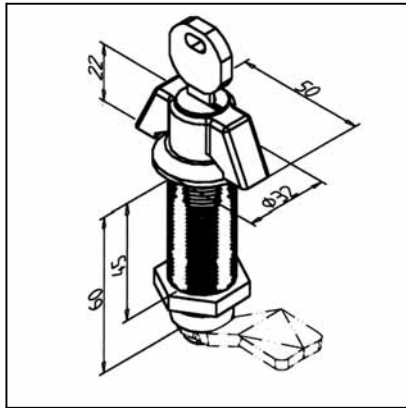

TECHN. DATA / ITEMS SUPPLIED

- GD Zn, chrome plated
- With profile cylinder lock
- Fixing nut, steel, zinc-plated
- Without lock
- Weight 0,198 kg

APPLICATIONS

- For profiles 45
- Locking of doors and lids in guard units

ASSEMBLY

- Bore \varnothing 22 mm in the middle of the profile
- Tighten T-handle lock from the rear with fixing nut
- Selection of locks see page 124

LOCKS

Fitting principles

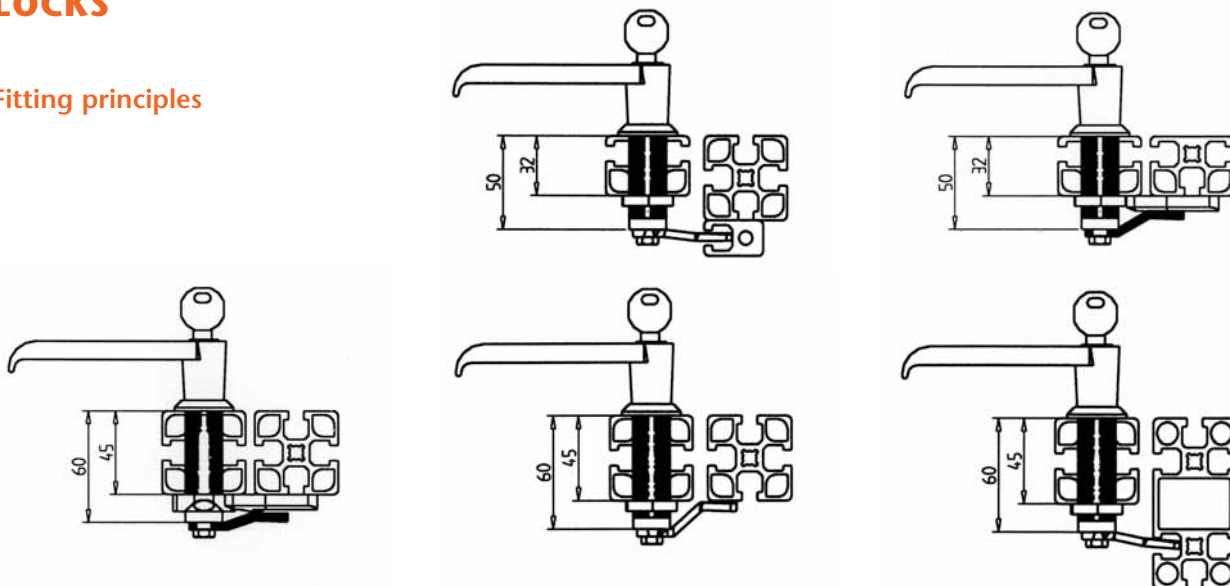

Selection of locks

Door profile	45 x 45 mm	32 x 45 mm	19 x 45 mm	Panel elements 4-8 mm
Lock	handle 45 or bolt lock 45	handle 32 or bolt lock 32	handle 32 or bolt lock 32	cylinder lock
Frame profile	Part number of locks			
90 x 45	21.1093/1	21.1093/0	21.1093/0	21.1093/2
45 x 45	21.1093/5	21.1093/3	21.1093/3	21.1093/2
with catch 19	21.1093/4	21.1093/2	21.1093/2	----
with door stop S	21.1093/3	----	----	----
32 x 45	----	21.1093/5	21.1093/5	21.1093/5
with catch 19	----	21.1093/4	21.1093/4	----

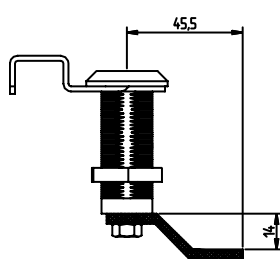

Part no. 21.1093/0

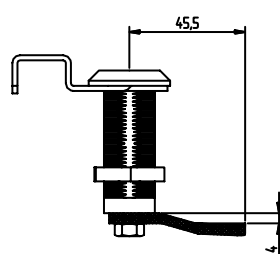

Part no. 21.1093/1

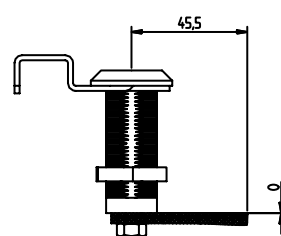

Part no. 21.1093/2

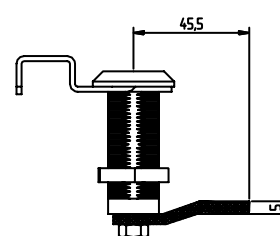

Part no. 21.1093/3

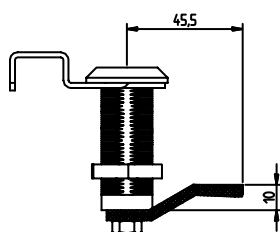

Part no. 21.1093/4

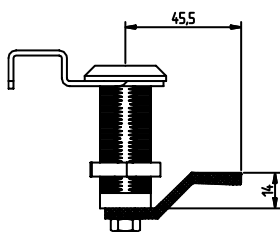

Part no. 21.1093/5

ROD LOCK

Items supplied

- Bolt lock, steel with square key
- Optional: handle or handle with cylinder lock
- Latch with rod connections, steel, galvanized
- Latch with rollers (l = 1100 mm), steel, galvanized
- Rod guiding element, PA with nut M6

Applications

- For locking doors at upper or lower beam
- Use 2 rods for 2-sided locking
- Order bolt lock, handle without lock or handle with cylinder lock
- Especially suited for control boxes or double-sided doors

Assembly

- 1) Mill bore $\varnothing 22,5$ mm as shown in figure below
- 2) Fix rod guide with set screw M6 x 30 at desired position. No drilling necessary. Screw square nut loose onto set screw. Insert the square nut into the profile groove and twist the plastic part until the guide is fixed.
- 3) Attach bolt lock or handle.
- 4) Insert rod into guiding element and connect with latch.

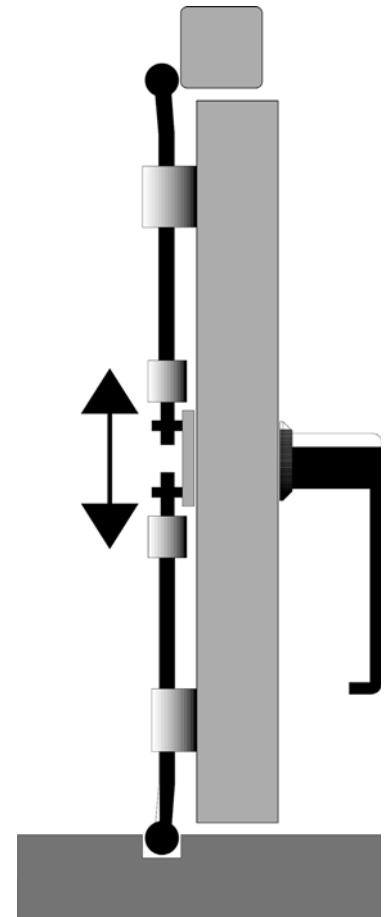
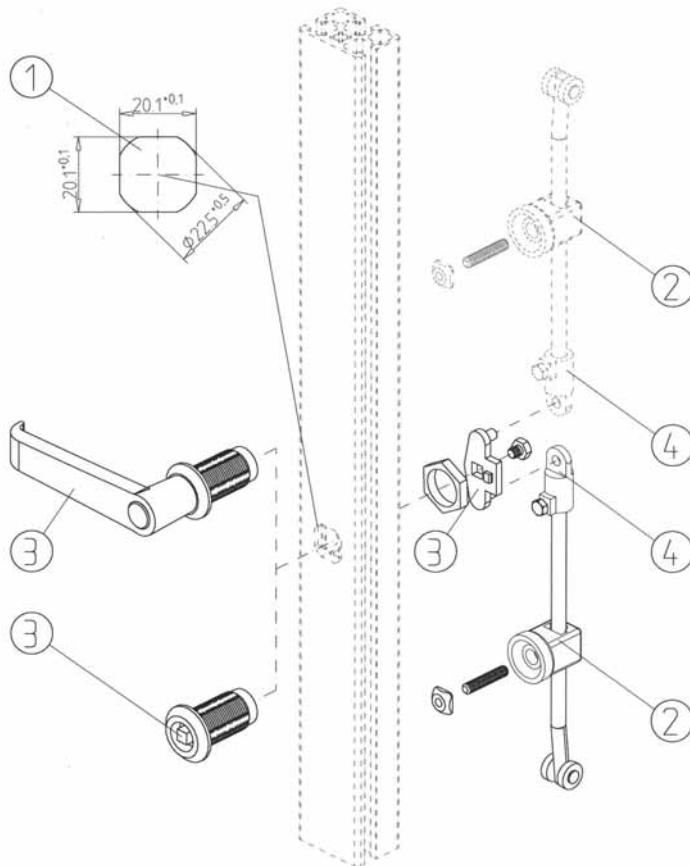
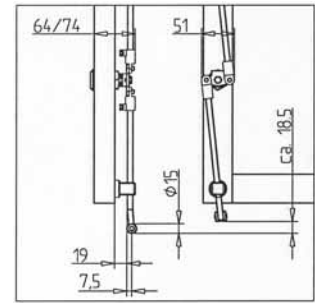

Profile	Bolt lock		Handle without lock		Handle with cylinder lock	
	1 rod	2 rods	1 rod	2 rods	1 rod	2 rods
32 x 45	21.1798/0	21.1798/2	21.1798/3	21.1798/4	21.1798/5	21.1798/6
45 x 45	21.1788/0	21.1788/2	21.1788/3	21.1788/4	21.1788/5	21.1788/6

ROD LOCK WITH SPRING RETENTION

Part N° 21.1490/0

Items supplied

- 1: 1 Lock
- 2: 1 Handle
- 3: 2 spring retentions
- 4: Adaptors for rods
- 5: Rod with lug (Lmax = 1200)

Optional:

- 6: Cable channel 45 Al
- 7: Protecting cap for cable channel
- 8: Cable clip 45

Applications

- For locking doors at upper and lower beam
- Especially suited for doors in frames
- Max. door height 2760 mm

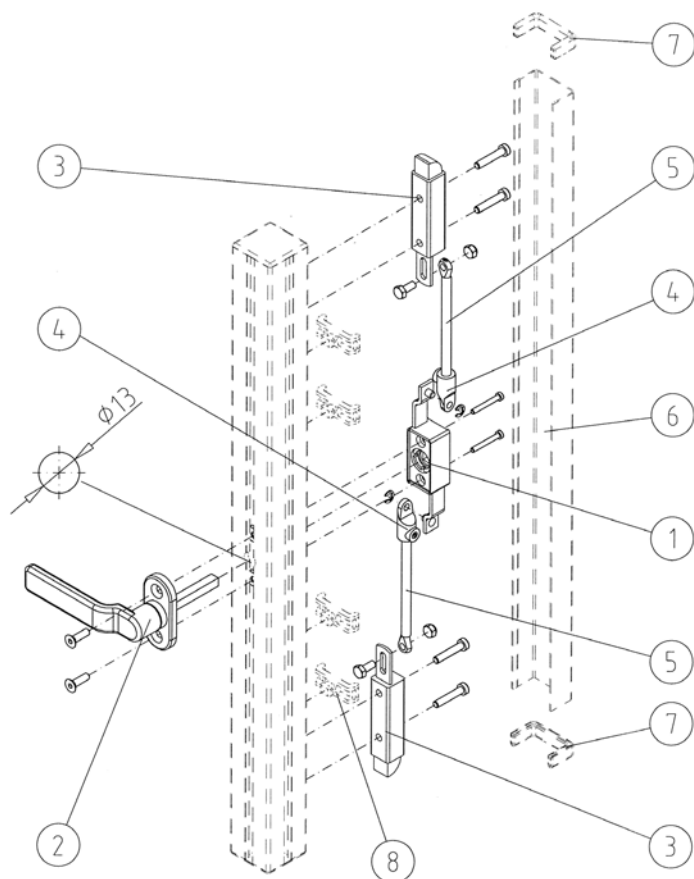
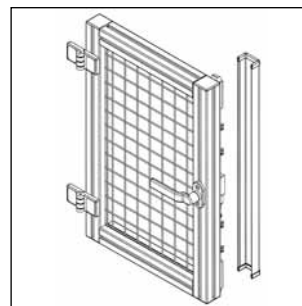
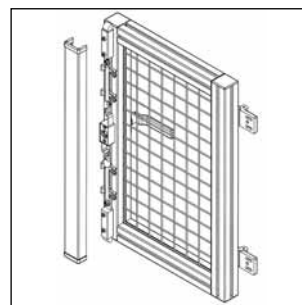

Assembly

- a) Bore $\varnothing 13$ in vertical door profile
- b) Screw lock and spring retentions at door profile, clip cable clips for conduit 45 at appropriate positions
- c) Cut rods according to your door-size. Mount adaptors at rod-ends. Link rods with lock and spring retentions
- d) Insert handle and fix
- e) Adjust slam-lock
- f) Assemble optional cable channel

Choose door hinges for slam-bolts according to mounting situation.

CATCH 19

Part. N° 21.1755/0

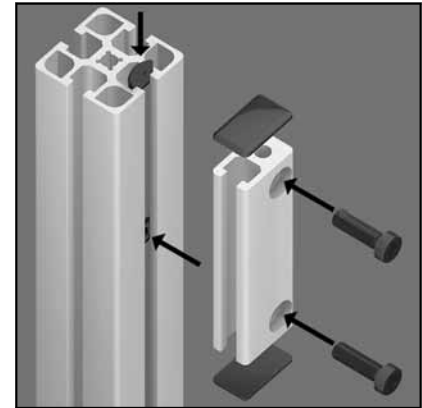
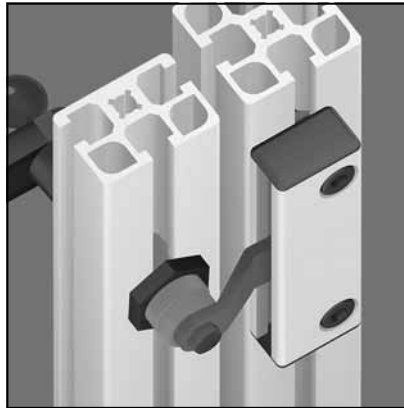
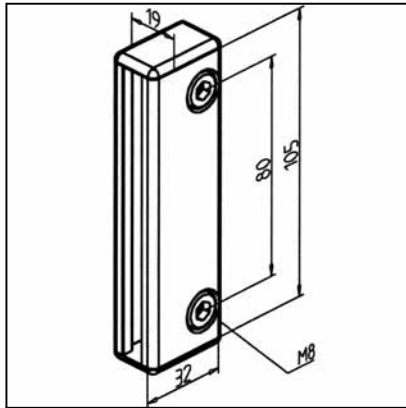

TECHN. DATA / ITEMS SUPPLIED

- Profile 19 x 32
- End caps
- Fixing kit
- Weight 0,040 kg

APPLICATIONS

- Locking of doors and lids in connection with handles and bolt locks

ASSEMBLY

- Use fixing kit from supply schedule
- Selection of locks see page 124

DOOR HANDLE

Part. N° 21.1748/0

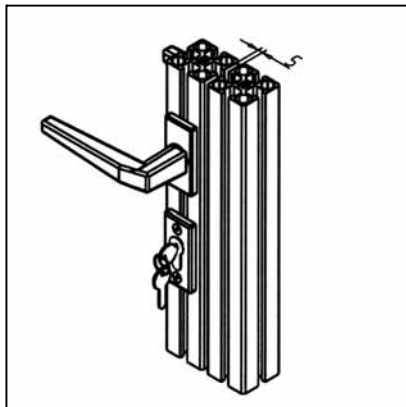

TECHN. DATA / ITEMS SUPPLIED

- Lock housing steel, zinc plated, fitted into profile 45 x 45
- Fittings, aluminium, anodized
- Profile cylinder with 3 keys, mounted
- Weight 0,850 kg
- Weight + 1,950 kg/m
- When ordering, please indicate the required profile length

APPLICATIONS

- Swing doors for guard units

ASSEMBLY

- Allow 5 mm space between door and frame
- Door lock meshes into groove of opposite profile
- Position horizontal profile offside lock area or use counter sunk screw M8 x 25

BALL LATCH 50

Part. N° 21.1763/0

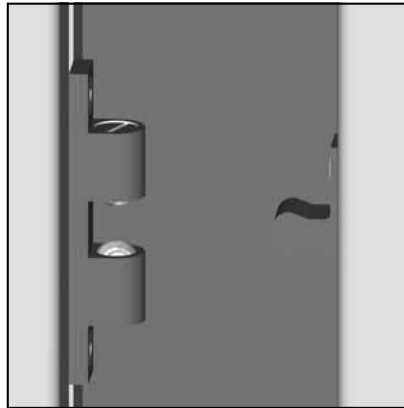
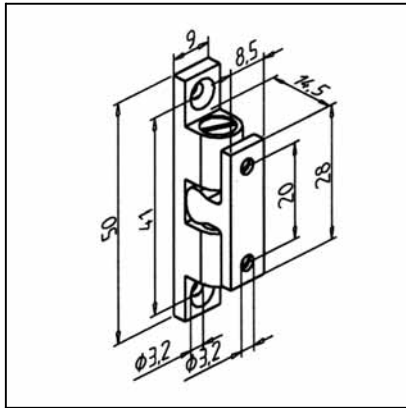

TECHN. DATA / ITEMS SUPPLIED

- Brass
- Holding force adjustable 10 - 50 N
- Fixing kit
- Weight 0,030 kg

APPLICATIONS

- Stop and catch for swing- and sliding doors
- The latch housin fits into profile groove. This allows gap-free closing of sliding doors
- Doors, lids, removable panel elements

ASSEMBLY

- Use fixing kit from supply schedule
- Holding plate on profile surface with self-tapping screws

BALL LATCH SUPPORT 50

Part. N° 21.1139/0

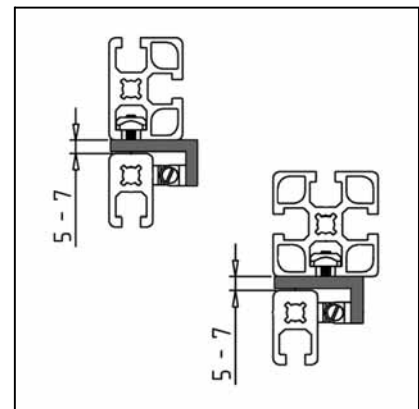
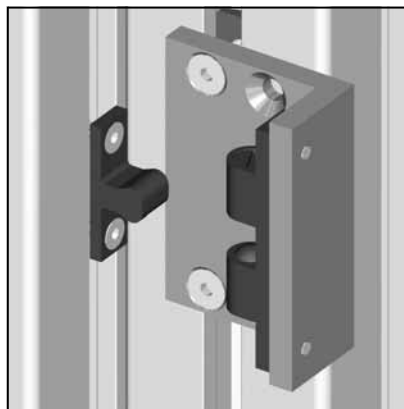
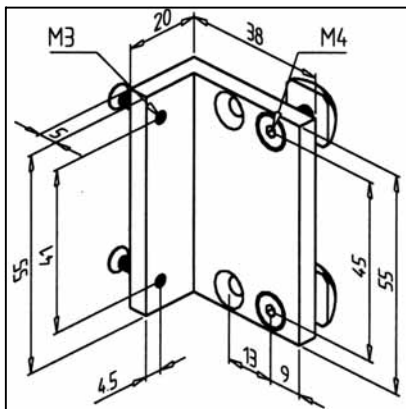

TECHN. DATA / ITEMS SUPPLIED

- Aluminium, natural, anodized
- Fixing kit
- Weight 0,050 kg

APPLICATIONS

- Attachment of ball latch 50 in doors, lids
- Removable panel elements
- Door stop

ASSEMBLY

- Use fixing kit from supply schedule

BALL LATCH 70

Part. N° 21.1757/0

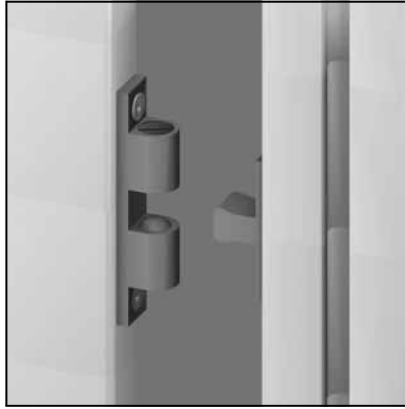
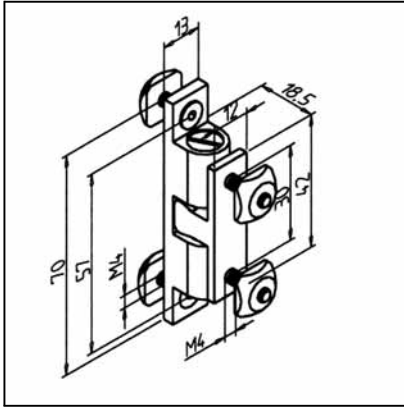

TECHN. DATA / ITEMS SUPPLIED

- Brass
- Holding force adjustable between 50 - 150 N
- Fixing kit
- Weight 0,095 kg

APPLICATIONS

- Quick attachment of easy to remove panel elements
- Stop and catch for sliding doors, swing doors, lids

ASSEMBLY

- Use fixing kit from supply schedule

BALL LATCH SUPPORT 70

Part. N° 21.1137/0

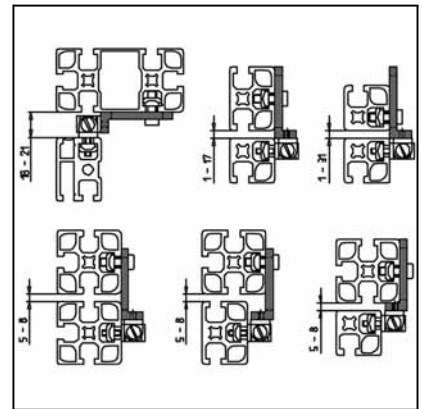
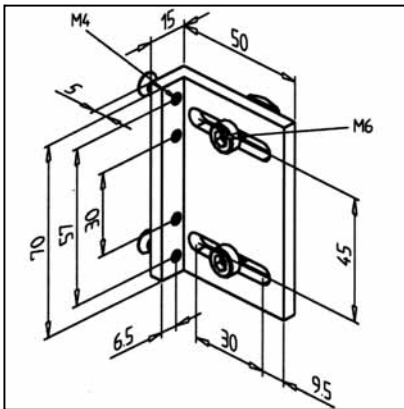

TECHN. DATA / ITEMS SUPPLIED

- Aluminium, natural, anodized
- Fixing kit
- Weight 0,050 kg

APPLICATIONS

- Attachment of ball latch 70 in doors, lids, removable panel elements
- Door stop
- If using profile 32, ball latch support has to be shortened

ASSEMBLY

- Use fixing kit from supply schedule

DOOR CATCH

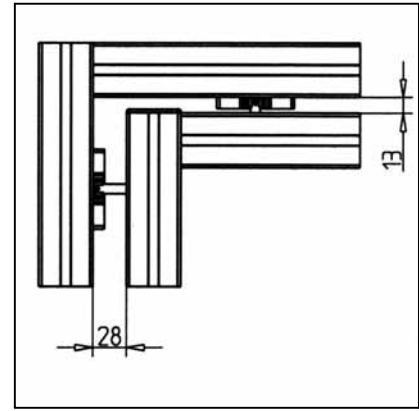
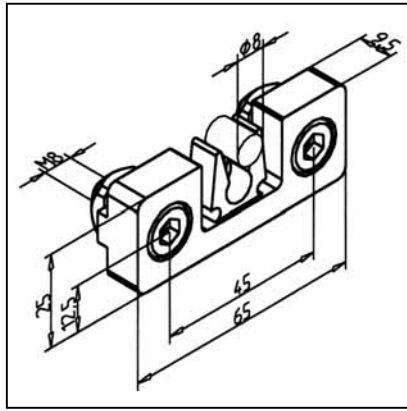

Part. N° 21.1756/1

TECHN. DATA / ITEMS SUPPLIED

- PA 6, grey
- On request also deliverable in black
Part N° 21.1756/0
- Fixing kit
- Weight 0,041 kg
- Holding force between 50 - 70 N

APPLICATIONS

- Quick catch of doors and lids
- Function in connection with snap bolt
- Roller carrier for transport rollers

ASSEMBLY

- Mount on all profiles with fixing kit from supply schedule
- Alternative use of snap bolt 25 or 40

DOOR STOP S

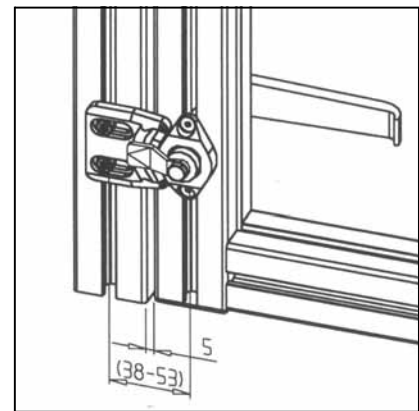
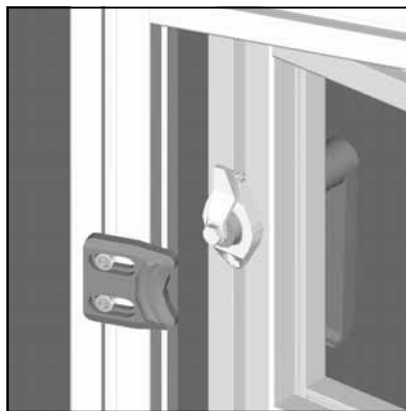
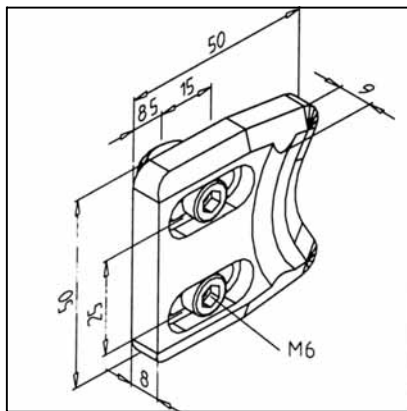

Part. N° 21.1767/0

TECHN. DATA / ITEMS SUPPLIED

- GD Zn, black
- Fixing kit
- Weight 0,077 kg

APPLICATIONS

- Adjustable stop for swing-doors
- Especially designed for use in combination with handles, bolt-locks or t-handles
- Also door catch

ASSEMBLY

- Screw with fixing kit on door-frame
- See page 124

TWIST-STOP

Part. N° 21.1768/0

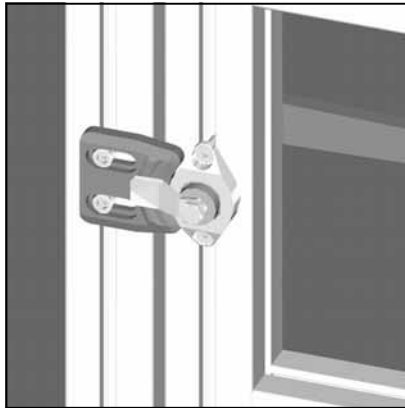
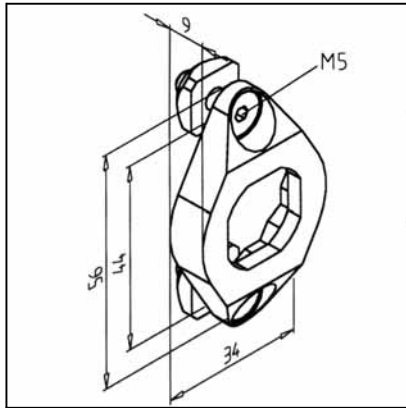

TECHN. DATA / ITEMS SUPPLIED

- GD Zn, black

- Fixing kit

- Weight 0,04 kg

APPLICATIONS

- Protection of bolt-locks, handles and T-handles against unwanted loosening or overturning

- In particular fitting in combination with Door Stop S Part N° 21.1767/0

ASSEMBLY

- Mount handle or bolt-lock as usual

- Fix Twist-Stop using fixing kit

- Mount lock

SNAP BOLT 25

Part. N° 21.1758/0

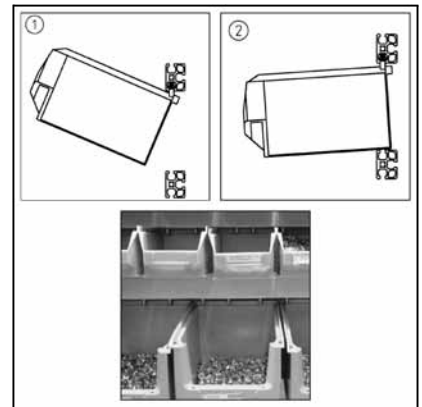
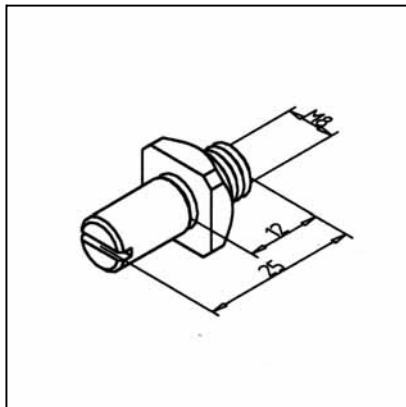

TECHN. DATA / ITEMS SUPPLIED

- Steel, zinc plated

- With square nut, zinc plated

- Weight 0,010 kg

APPLICATIONS

- Door catches

- Attachment of grab trays in work benches between 2 profiles

- Supports

ASSEMBLY

- Use fixing kit from supply schedule

SNAP BOLT 40

Part. N° 21.1760/0

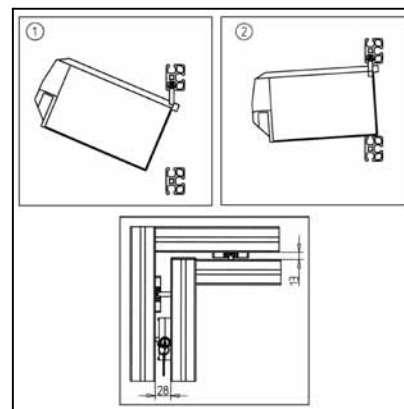
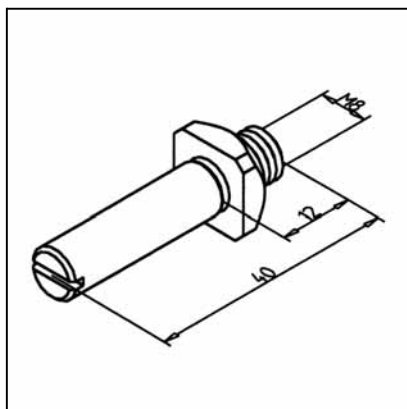

TECHN. DATA / ITEMS SUPPLIED

- Steel, zinc plated
- With square nut, zinc plated
- Weight 0,020 kg

APPLICATIONS

- Door catches
- Attachment of grab trays in work benches between 2 profiles
- Supports

ASSEMBLY

- Screw with square nut in profile groove

LOCK FOR DOUBLE DOOR

Part. N° 21.0990/0

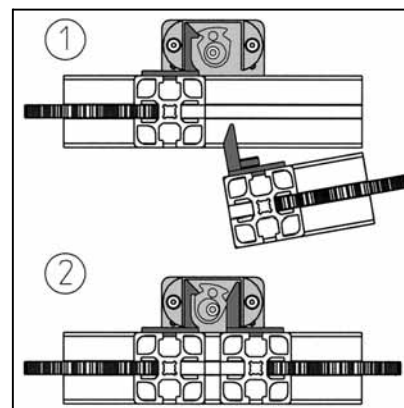
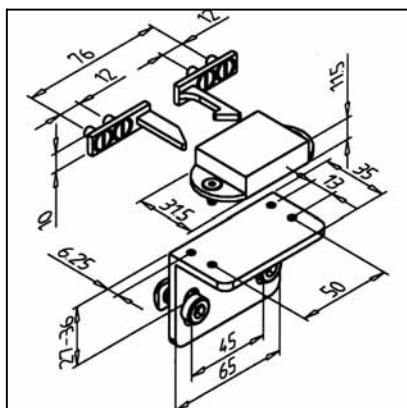

TECHN. DATA / ITEMS SUPPLIED

- GD Zn, chrome plated
- 2 locks
- Holding angel
- Fixing kit
- Weight 0,145 kg

APPLICATIONS

- Locking of double doors with only one profile cylinder lock
- After Insertion of the second tongue, the first door cannot be opened. A lockin mechanism on the second door suffice for bolting

ASSEMBLY

- Fix lock angle upper or lower frame, position at door folding, Select the threads according to the profiles used for the doors
- Screw catches on door-wings and adjust to lock

TRUNK-LOCK

Part. N° 21.1764/0

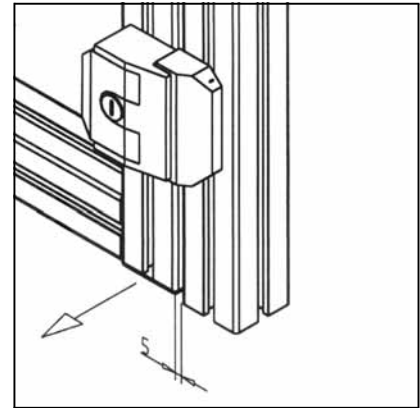
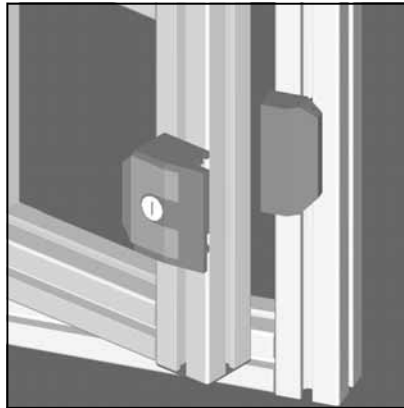
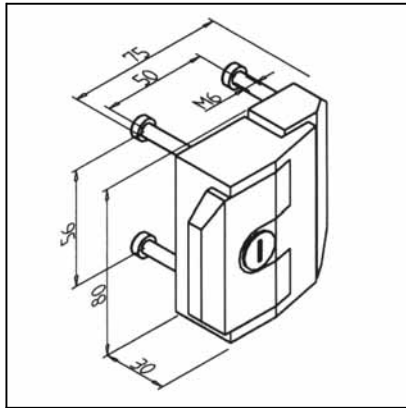

TECHN. DATA / ITEMS SUPPLIED

- GD Zn, black
- Lock with 2 keys
- Fixing kit
- Weight 0,55 kg

APPLICATIONS

- Locking of door or lids
- No additional door-stop necessary
- Useable for frameless doors

ASSEMBLY

- Insert screws of fixing kit in lock and stop
- Drill trough-holes \varnothing 6,5 mm in door and post with a distance of 56 mm
- Screw both parts from backside

MAGNETIC CATCH

Part. N° 21.1753/0

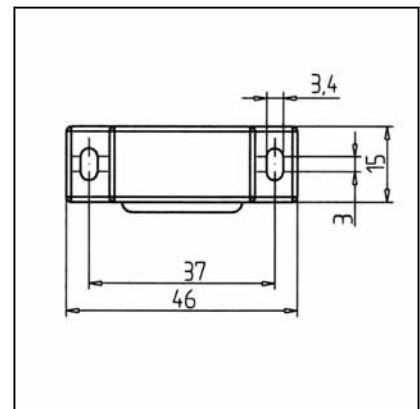
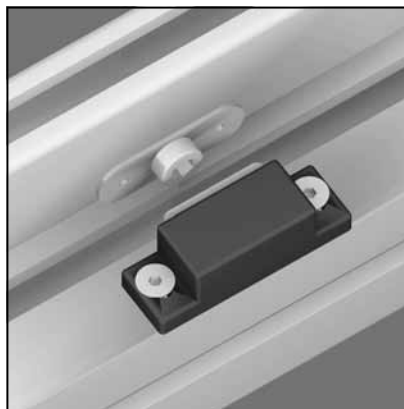
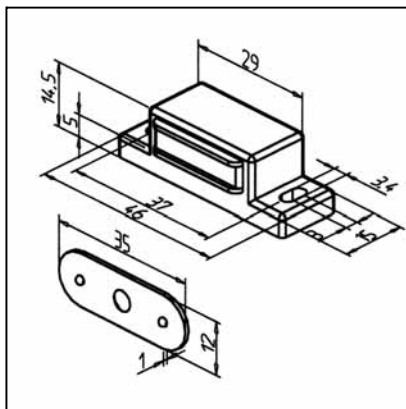

TECHN. DATA / ITEMS SUPPLIED

- Housing PA 6, black
- Holding plate, steel, zinc plated
- Fixing kit
- Weight 0,021 kg

APPLICATIONS

- Quick catch for swing-doors
- Attachment of light panel elements

ASSEMBLY

- Mount with fixing kit on profile surface

MAGNETIC CATCH N

Part. N° 21.1741/0

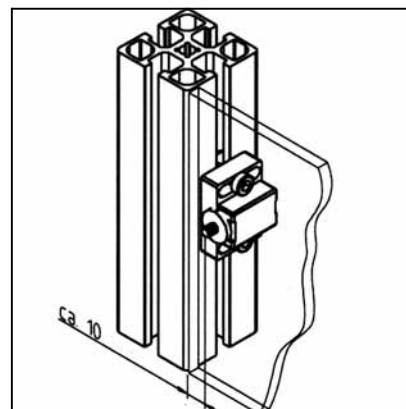
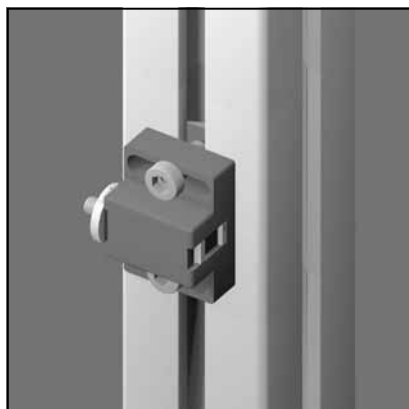
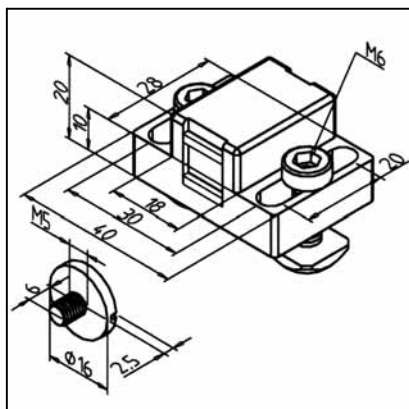

TECHN. DATA / ITEMS SUPPLIED

- Housing PA 6, grey
- Holding plate, steel, zinc plated
- Fixing kit
- Weight 0,060 kg
- Holding force between 30 - 40 N

APPLICATIONS

- Stop and quick catch for swing doors
- Fastening of light panel elements

ASSEMBLY

- Use fixing kit from supply schedule
- Opposite plate directly on profile surface or panel element; thread M5 required

MAGNETIC CATCH S

Part. N° 21.1740/0

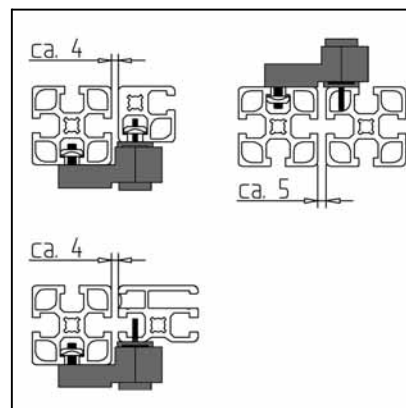
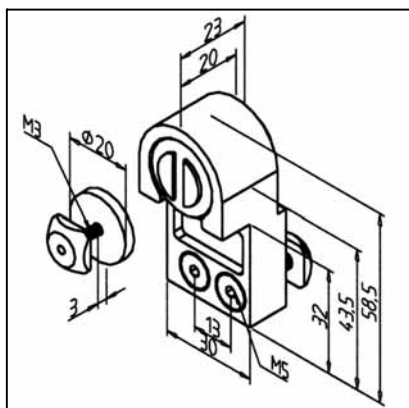

TECHN. DATA / ITEMS SUPPLIED

- Housing PA, grey
- Holding plate, steel, zinc plated
- Fixing kit
- Weight 0,080 kg
- Holding force between 50 - 75 N

APPLICATIONS

- Stop and quick catch for swing doors
- Fastening of light panel elements

ASSEMBLY

- Use fixing kit from supply schedule
- Opposite plate directly on profile surface or panel element; thread M3 required

STOPPER 25

Part. N° 21.1759/0

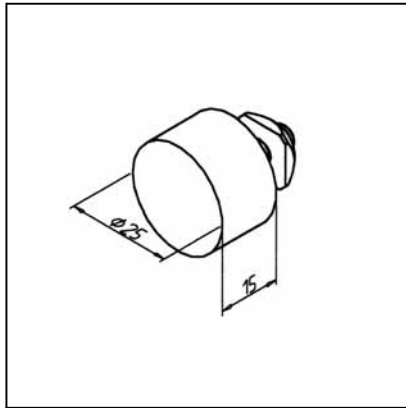

TECHN. DATA / ITEMS SUPPLIED

- NBR, black

- Square nut M6, zinc plated

- Weight 0,020 kg

APPLICATIONS

- Stop for doors, linear guides

ASSEMBLY

- Fix with square nut M6 in profile groove

STOPPER 30

Part. N° 21.1759/1

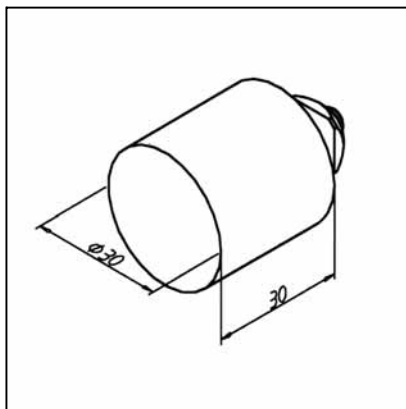

TECHN. DATA / ITEMS SUPPLIED

- NBR, black

- Square nut M8, zinc plated

- Weight 0,060 kg

APPLICATIONS

- Stop for heavy doors, linear guides

ASSEMBLY

- Fix with square nut M8 in profile groove